

# BULKHEAD NUTSTRAP, SELF-LOCKING, LOW PERMEABILITY

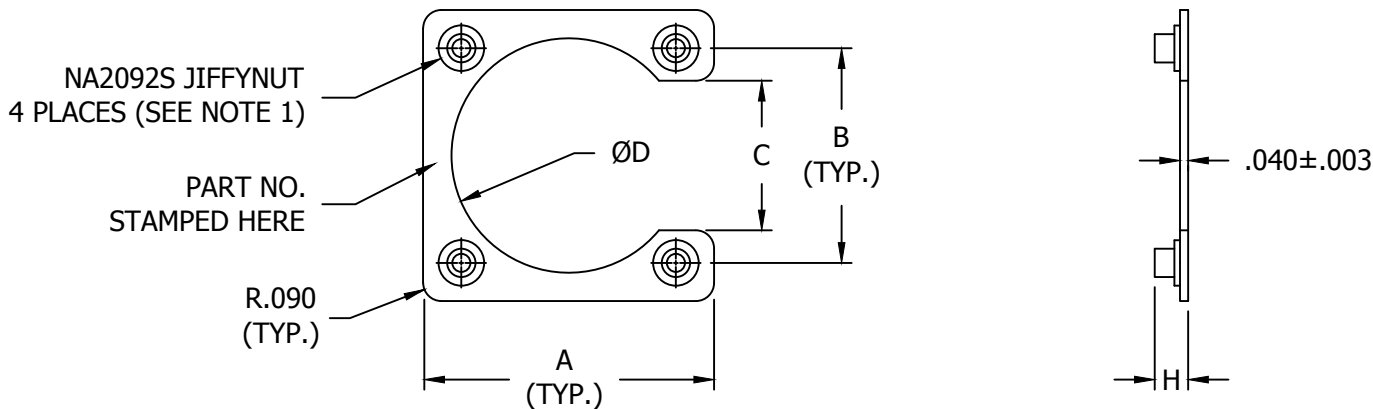

TABLE I - DIMENSIONS AND DASH NUMBERS

NAFCO PART NUMBER	SHELL SIZE	A ±.015	B ±.003	C ±.020	D +.015 -.000	H ±.015	THREAD (AS8879)	NAFCO JIFFYNUT PART NO.
NA2130-3	3	.925	.625	.325	.641	.156	.1120-40 UNJC-3B	NA2092S-40L
NA2130-6	6	.755	.469	.183	.535	.156	.1120-40 UNJC-3B	NA2092S-40L
NA2130-7	7	1.019	.719	.433	.688	.156	.1120-40 UNJC-3B	NA2092S-40L
NA2130-8	8	.880	.594	.308	.554	.156	.1120-40 UNJC-3B	NA2092S-40L
NA2130-10	10	1.019	.719	.433	.688	.156	.1120-40 UNJC-3B	NA2092S-40L
NA2130-12	12	1.098	.812	.526	.828	.156	.1120-40 UNJC-3B	NA2092S-40L
NA2130-14	14	1.192	.906	.620	.953	.156	.1120-40 UNJC-3B	NA2092S-40L
NA2130-16	16	1.255	.969	.683	1.094	.156	.1120-40 UNJC-3B	NA2092S-40L
NA2130-18	18	1.348	1.062	.776	1.185	.156	.1120-40 UNJC-3B	NA2092S-40L
NA2130-19	19	1.192	.906	.620	.953	.156	.1120-40 UNJC-3B	NA2092S-40L
NA2130-20	20	1.500	1.156	.865	1.305	.156	.1120-40 UNJC-3B	NA2092S-40L
NA2130-22	22	1.593	1.250	.907	1.428	.156	.1120-40 UNJC-3B	NA2092S-40L
NA2130-24	24	1.750	1.375	1.000	1.560	.173	.1380-32 UNJC-3B	NA2092S-62L
NA2130-27	27	1.255	.969	.683	1.094	.156	.1120-40 UNJC-3B	NA2092S-40L
NA2130-28	28	2.000	1.562	1.125	1.820	.173	.1380-32 UNJC-3B	NA2092S-62L
NA2130-32	32	2.312	1.750	1.188	2.062	.173	.1380-32 UNJC-3B	NA2092S-62L
NA2130-36	36	2.500	1.938	1.375	2.312	.173	.1380-32 UNJC-3B	NA2092S-62L
NA2130-37	37	1.500	1.187	.874	1.281	.156	.1120-40 UNJC-3B	NA2092S-40L
NA2130-61	61	1.812	1.437	1.062	1.594	.156	.1120-40 UNJC-3B	NA2092S-40L

**MATERIAL:**

PLATE -- 2024-T3 ALUMINUM PER AMS-QQ-A-250/4.  
NUT -- TYPE 303 CRES PER ASTM A581 OR ASTM A582.

**FINISH:**

PLATE -- ALODINE PER MIL-DTL-5541.  
NUT -- PASSIVATED PER AMS 2700 PLUS DRY FILM LUBRICANT PER A55272.

**SERVICE TEMP:**

TO 250° F.

**VARIATIONS:**

FOR OTHER SIZES AND MATERIALS CONTACT NAFCO USA, LLC.

**APPLICATION:**

FOR USE IN LIEU OF SELF-LOCKING HEX NUTS FOR MOUNTING ELECTRICAL RECEPTACLES TO BULKHEADS OR FLANGES, ETC.

**NOTES:**

1. THE JIFFYNUT IS A MECHANICALLY LOCKED-IN SELF-LOCKING NUT MEETING THE REQUIREMENTS OF NASM45938.
2. CE103S NUT MAY BE USED UNTIL ALL INVENTORY IS DEPLETED.

**EXAMPLE CALLOUT:**

NA2130 S - 12

BASIC PART NUMBER

NO. 12 SHELL SIZE

CORROSION RESISTANT STEEL

CONFORMS TO:

NASM45938

AS8879

# NAFCO USA, LLC

CARSON CITY, NV 89706

PART NUMBER

# NA2130

FSC / CAGE CODE: 32387