

BULKHEAD NUTSTRAP, SELF-LOCKING, WIDE FLANGE

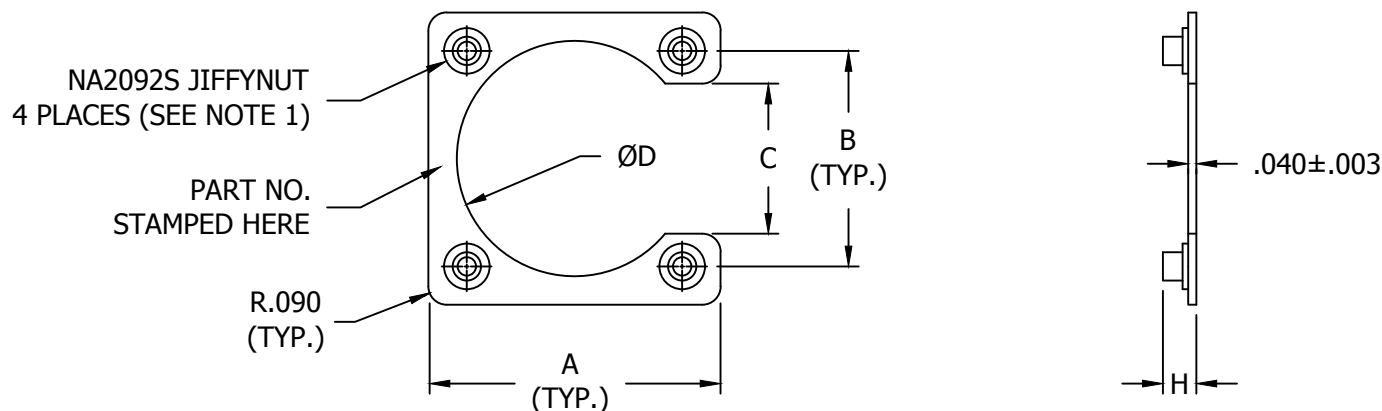

TABLE I - DIMENSIONS AND DASH NUMBERS

NAFCO PART NUMBER	SHELL SIZE	A ±.015	B ±.003	C ±.020	D ±.005	H MAX	THREAD (AS8879)	NAFCO JIFFYNUT PART NO. ©
NA2164-8	8	1.065	.734	.308	.568	.171	.1120-40 UNJC-3B	NA2092-40L
NA2164-10	10	1.144	.812	.433	.685	.171	.1120-40 UNJC-3B	NA2092-40L
NA2164-12	12	1.286	.938	.526	.864	.171	.1120-40 UNJC-3B	NA2092-40L
NA2164-14	14	1.380	1.031	.620	.989	.171	.1120-40 UNJC-3B	NA2092-40L
NA2164-16	16	1.453	1.125	.683	1.113	.171	.1120-40 UNJC-3B	NA2092-40L
NA2164-18	18	1.532	1.203	.776	1.238	.171	.1120-40 UNJC-3B	NA2092-40L
NA2164-20	20	1.688	1.297	.865	1.363	.171	.1120-40 UNJC-3B	NA2092-40L
NA2164-22	22	1.766	1.375	.907	1.488	.171	.1120-40 UNJC-3B	NA2092-40L
NA2164-24	24	1.891	1.500	1.000	1.615	.195	.1380-32 UNJC-3B	NA2092-62L

MATERIAL: PLATE -- 2024-T3 ALUMINUM PER AMS-QQ-A-250/4.
NUT -- NO CODE -- CARBON OR ALLOY STEEL- HEAT TREATED.
S CODE -- TYPE 303 CRES PER ASTM A581 OR ASTM A582.

FINISH: PLATE -- ALODINE PER MIL-DTL-5541.
NUT -- NO CODE -- CADMIUM PLATED PER AMS-QQ-P-416, TYPE II, CLASS 3, PLUS DRY FILM LUBRICANT PER AS5272.
S CODE -- PASSIVATED PER AMS2700 PLUS DRY FILM LUBRICANT PER AS5272.

SERVICE TEMP: TO 250°F.

VARIATIONS: FOR OTHER SIZES AND MATERIALS CONTACT NAFCO USA, LLC.

APPLICATION: FOR USE IN LIEU OF SELF-LOCKING HEX NUTS FOR MOUNTING ELECTRICAL RECEPTACLES TO BULKHEADS OR FLANGES, ETC.
FOR USE WITH SQUARE WIDE FLANGE MOUNT RECEPTACLES PER MIL-C-83723 SERIES I BAYONET.

NOTES:
1. THE JIFFYNUT IS A MECHANICALLY LOCKED-IN SELF-LOCKING NUT MEETING THE REQUIREMENTS OF NASM45938.
2. NA2164 SERIES ASSEMBLED WITH NA2092-() NUT.
NA2164S SERIES ASSEMBLED WITH NA2092S-() NUT.

EXAMPLE CALLOUT: NA2164 S - 12
BASIC PART NUMBER NO. 12 SHELL SIZE
CORROSION RESISTANT STEEL

CONFORMS TO:
NASM45938
MIL-C-83723/1
AS8879

NAFCO USA, LLC
CARSON CITY, NV 89706

PART NUMBER
NA2164
FSC / CAGE CODE: 32387