

# BULKHEAD NUTSTRAP, SELF-LOCKING, LOW PERMEABILITY

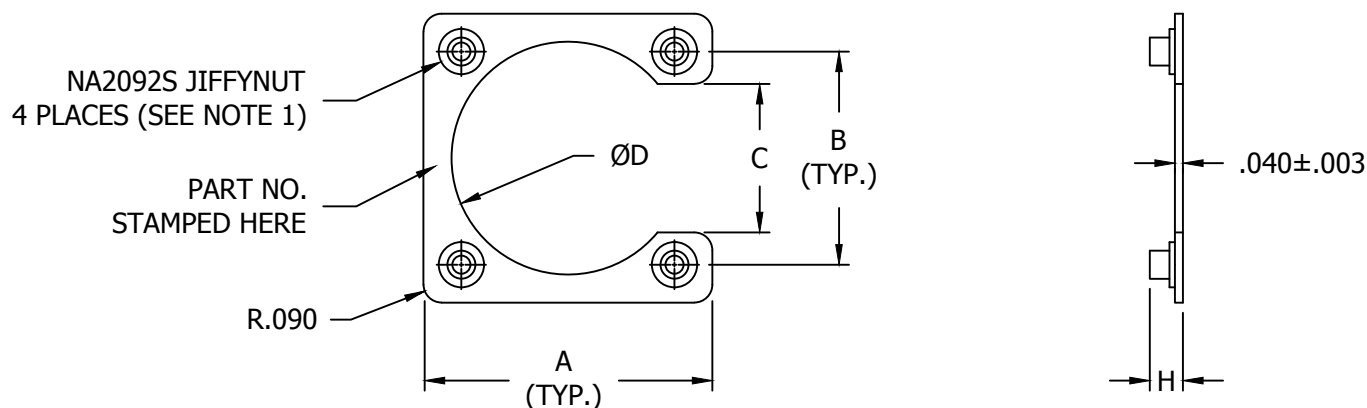

TABLE I - DIMENSIONS AND DASH NUMBERS

NAFCO PART NO.	SHELL SIZE	THREAD (AS8879)	A ±.015	B ±.003	C ±.020	D +.015 -.000	H MAX.	MILITARY PART NO.
NA2188-1	3	.1120-40	.925	.625	.310	.641	.166	M85528/2-3-A-01
NA2188-2	6	.1120-40	.755	.469	.168	.535	.166	M85528/2-6-A-01
NA2188-3	7	.1120-40	1.019	.719	.418	.688	.166	M85528/2-7-A-01
NA2188-4	8	.1120-40	.880	.594	.293	.570	.166	M85528/2-8-A-01
NA2188-5	10	.1120-40	1.019	.719	.418	.720	.166	M85528/2-10-A-01
NA2188-6	10	.1380-32	1.187	.812	.418	.749	.183	M85528/2-10-B-01
NA2188-7	12	.1120-40	1.104	.812	.515	.855	.166	M85528/2-12-A-01
NA2188-8	12	.1380-32	1.132	.938	.611	.938	.183	M85528/2-12-B-01
NA2188-9	14	.1120-40	1.198	.906	.609	.984	.166	M85528/2-14-A-01
NA2188-10	14	.1380-32	1.406	1.031	.605	1.031	.183	M85528/2-14-B-01
NA2188-11	16	.1120-40	1.280	.969	.672	1.094	.166	M85528/2-16-A-01
NA2188-12	16	.1380-32	1.500	1.125	.668	1.125	.183	M85528/2-16-B-01
NA2188-13	18	.1120-40	1.406	1.062	.765	1.220	.166	M85528/2-18-A-01
NA2188-14	18	.1380-32	1.578	1.203	.761	1.234	.183	M85528/2-18-B-01
NA2188-15	19	.1120-40	1.192	.906	.605	.953	.166	M85528/2-19-A-01
NA2188-16	20	.1120-40	1.535	1.156	.859	1.345	.166	M85528/2-20-A-01
NA2188-17	20	.1380-32	1.688	1.297	.850	1.359	.183	M85528/2-20-B-01
NA2188-18	22	.1120-40	1.665	1.250	.953	1.478	.166	M85528/2-22-A-01
NA2188-19	22	.1380-32	1.738	1.375	.892	1.483	.183	M85528/2-22-B-01
NA2188-20	24	.1380-32	1.891	1.500	.985	1.560	.183	M85528/2-24-A-01
NA2188-21	24	.1380-32	1.785	1.375	1.016	1.595	.183	M85528/2-24-B-01
NA2188-22	25	.1380-32	1.891	1.500	1.110	1.658	.183	M85528/2-25-A-01
NA2188-23	27	.1120-40	1.255	.969	.668	1.094	.166	M85528/2-27-A-01
NA2188-24	28	.1380-32	2.000	1.562	1.110	1.820	.183	M85528/2-28-A-01
NA2188-25	32	.1380-32	2.312	1.750	1.173	2.062	.183	M85528/2-32-A-01
NA2188-26	36	.1380-32	2.500	1.938	1.360	2.312	.183	M85528/2-36-A-01
NA2188-27	37	.1120-40	1.500	1.187	.859	1.281	.166	M85528/2-37-A-01
NA2188-28	61	.1120-40	1.812	1.437	1.047	1.594	.166	M85528/2-61-A-01

SHEET 1 OF 2

CONFORMS TO:

 NASM45938  
 AS8879  
 MIL-C-85528/2

## NAFCO USA, LLC

CARSON CITY, NV 89706

PART NUMBER

## NA2188

FSC / CAGE CODE: 32387