

DOME NUT

TWO-LUG SELF-SEALING – SELF-LOCKING, FLOATING NUT ELEMENT

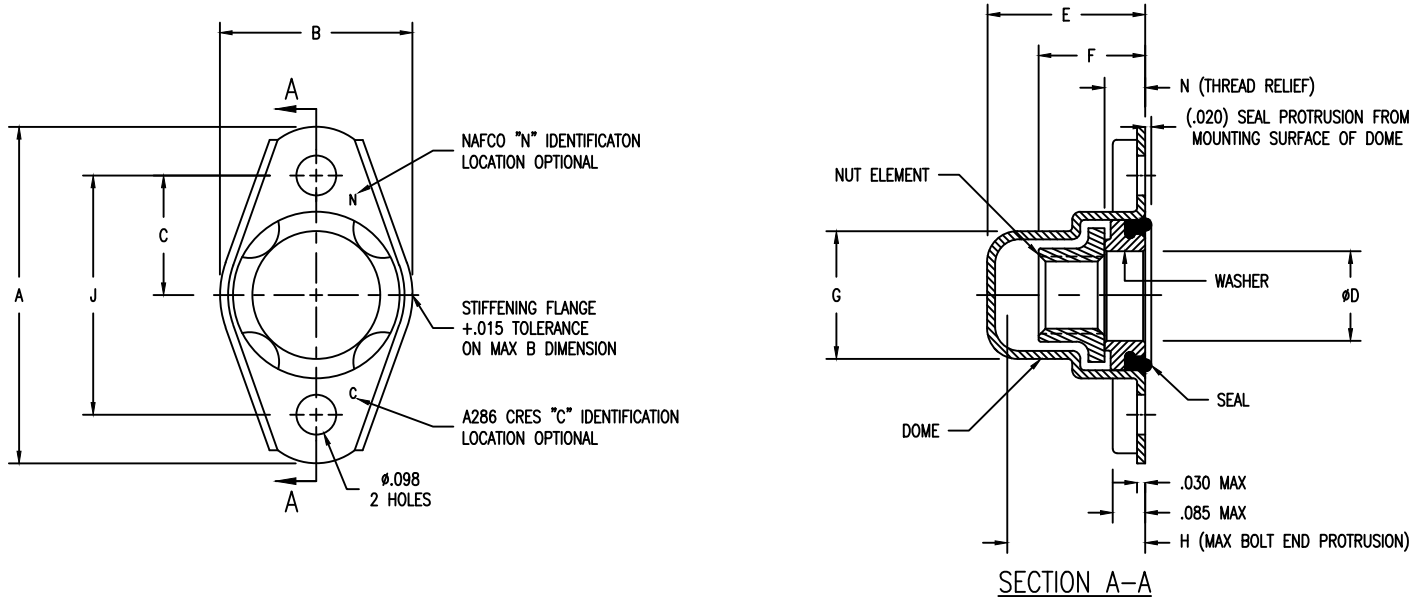

NAFCO PART NUMBER	THREAD (MIL-S-8879)	A MAX	B MAX	C ±.005	D MIN	E MAX	F MAX	G MAX	H MAX	J ±.002	N MIN	APPROXIMATE WEIGHT LBS/100 PCS.
NA2172-40	.1120-40 UNJC-3B	.840	.443	.295	.142	.405	.204	.352	.340	.590	.070	.41
NA2172-62	.1380-32 UNJC-3B				.173		.221					
NA2172-82	.1640-32 UNJC-3B				.194		.268					
NA2172-02	.1900-32 UNJF-3B				.220							
NA2172-048	.2500-28 UNJF-3B	1.000	.635	.376	.280	.560	.350	.419	.490	.752	.105	1.00

MATERIAL:

- NUT - CARBON OR ALLOY STEEL. A286 CRES PER AMS5525 OR AMS5732.
- DOME - CARBON STEEL GRADE C1050 PER AMS5085. A286 CRES PER AMS5525.
- WASHER - ALUMINUM ALLOY OR ALLOY STEEL. A286 CRES PER AMS5732.
- SEAL - 225°F: RUBBER, MIL-R-6855, CLASS I, GRADE 60, DUROMETER A60, COLOR BLACK.
350°F: FLUOROSILICONE RUBBER, MIL-R-25988, TYPE II, CLASS I, DUROMETER A70, COLOR BLUE.
450°F: SILICONE RUBBER, AMS3304, DUROMETER A70, COLOR RED.

FINISH:

- A CODE - STEEL NUT AND DOME WITH ALUMINUM ALLOY OR STEEL WASHER. FUEL RESISTANT MIL-R-6855 SEAL (225°F). STEEL NUT, DOME AND WASHER CAD PLATE PER QQ-P-416 TYPE II, CLASS 2. ALUMINUM WASHER ALODINE PER MIL-C-5541. NUT DRI-FILM LUBRICANT PER MIL-L-46010 OVER CAD PLATE.
- S CODE - STEEL NUT, DOME AND WASHER. FUEL RESISTANT MIL-R-25988 SEAL (350°F). STEEL NUT, DOME AND WASHER CAD PLATE PER QQ-P-416 TYPE II, CLASS 2. NUT DRI-FILM LUBRICANT PER MIL-L-46010 OVER CAD PLATE.
- X CODE - SAME AS "A CODE" WITHOUT DRI-FILM LUBRICANT.
- Y CODE - SAME AS "S CODE" WITHOUT DRI-FILM LUBRICANT.
- C CODE - A286 CRES NUT, DOME AND WASHER PASSIVATE PER QQ-P-35. NUT SILVER PLATE PER AMS2410. NON-FUEL RESISTANT AMS3304 SEAL (450°F).
- F CODE - A286 CRES NUT, DOME AND WASHER PASSIVATE PER QQ-P-35. NUT DRI-FILM LUBRICANT PER MIL-L-46010. FUEL RESISTANT MIL-R-25988 SEAL (350°F).
- R CODE - A286 CRES NUT, DOME AND WASHER PASSIVATE PER QQ-P-35. NUT DRI-FILM LUBRICANT PER MIL-L-46010. FUEL RESISTANT MIL-R-6855 SEAL (225°F).

SERVICE TEMP:

- MIL-R-6855 RUBBER -65°F TO 250°F
- MIL-R-25988 FLOUROSILICONE RUBBER -65°F TO 350°F
- AMS3304 RUBBER -65°F TO 450°F

VARIATIONS:

- K CODE - ADD AFTER DASH NUMBER FOR OPTIONAL STIFFENING FLANGE. EXAMPLE: NA2172C-02K.
- N CODE - ADD AFTER DASH NUMBER FOR NO STIFFENING FLANGE. EXAMPLE: NA2172C-02N.
- NO CODE - STIFFENING FLANGE AT MANUFACTURER'S OPTION.
- Z CODE - ADD AFTER DASH NUMBER FOR DOME AND WASHER TO BE COATED WITH A GALVANIC REACTION RESISTANT COATING PER NAS4006. EXAMPLE: NA2172C-02Z. SHALL BE IDENTIFIED WITH A PERMANENT SPOT, DAB OR PATCH OF YELLOW INDEPENDENT #73X INK APPLIED TO TOP OF DOME.

APPLICATION:

THE DOME OF THIS ASSEMBLY PREVENTS WIRE ABRASION, TRAPS METALLIC FLAKES AND PROTECTS BOLT THREADS AGAINST CONTAMINATION.

NOTES:

- MINIMUM RADIAL FLOAT SHALL BE .015. MAXIMUM AXIAL FLOAT SHALL BE .030.
- NUT ELEMENT SHALL BE CAPABLE OF ENGAGEMENT WITH A BOLT IN THE MAXIMUM MISALIGNED POSITION.
- PRESSURE RANGE IS 0 TO 50 PSIG.

EXAMPLE CALLOUT: NA2172C - 02KZ

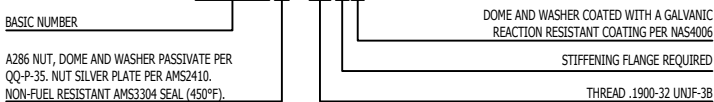

A286 NUT, DOME AND WASHER PASSIVATE PER QQ-P-35. NUT SILVER PLATE PER AMS2410. NON-FUEL RESISTANT AMS3304 SEAL (450°F).

CONFORMS TO:
NASM25027
MIL-S-8879
NAS1474

NAFCO USA, LLC

CARSON CITY, NV 89706

PART NUMBER
NA2172

CAGE CODE: 32387