

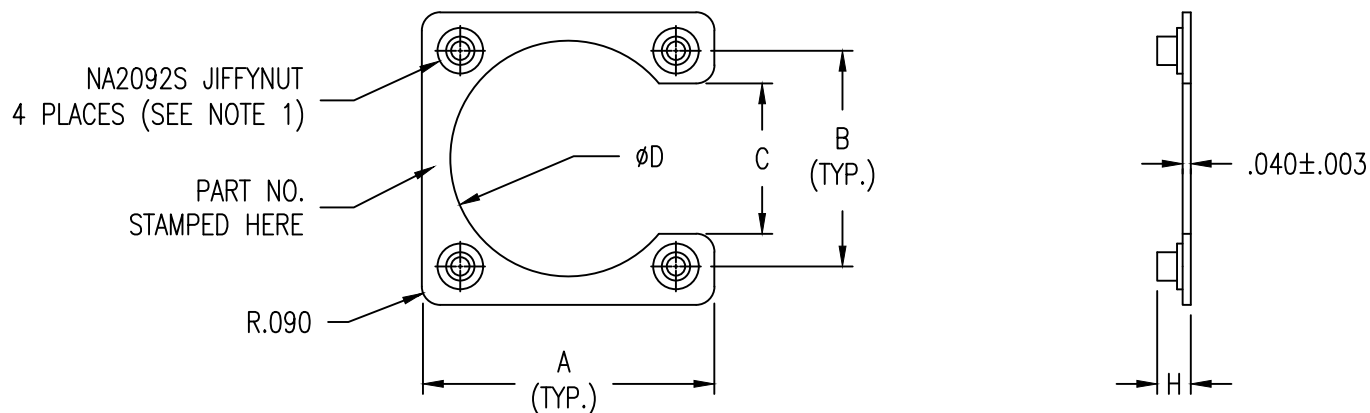

BULKHEAD NUTSTRAP

SELF-LOCKING, LOW PERMEABILITY



| NAFCO PART NUMBER | SHELL SIZE | A ±.015 | B ±.005 | C ±.010 | D DIA. MIN. | H MAX. | THREAD (MIL-S-8879) | NAFCO JIFFYNUT PART NO. |
|----------------------|---------------|------------|------------|------------|-------------------|-----------|------------------------|-------------------------------|
| CE102S-3 | 3 | .94 | .625 | .31 | .636 | .165 | .1120-40 UNJC-3B | NA2092S-40L |
| CE102S-7 | 7 | 1.00 | .719 | .41 | .703 | .165 | .1120-40 UNJC-3B | NA2092S-40L |
| CE102S-8 | 8 | .84 | .594 | .29 | .530 | .165 | .1120-40 UNJC-3B | NA2092S-40L |
| CE102S-10 | 10 | .97 | .718 | .34 | .660 | .165 | .1120-40 UNJC-3B | NA2092S-40L |
| CE102S-12 | 12 | 1.12 | .813 | .50 | .828 | .165 | .1120-40 UNJC-3B | NA2092S-40L |
| CE102S-14 | 14 | 1.22 | .906 | .60 | .910 | .165 | .1120-40 UNJC-3B | NA2092S-40L |
| CE102S-16 | 16 | 1.43 | .969 | .65 | 1.030 | .165 | .1120-40 UNJC-3B | NA2092S-40L |
| CE102S-18 | 18 | 1.44 | 1.062 | .74 | 1.160 | .165 | .1120-40 UNJC-3B | NA2092S-40L |
| CE102S-19 | 19 | 1.25 | .906 | .59 | .953 | .165 | .1120-40 UNJC-3B | NA2092S-40L |
| CE102S-20 | 20 | 1.67 | 1.156 | .82 | 1.290 | .165 | .1120-40 UNJC-3B | NA2092S-40L |
| CE102S-22 | 22 | 1.75 | 1.250 | .92 | 1.410 | .165 | .1120-40 UNJC-3B | NA2092S-40L |
| CE102S-24 | 24 | 1.88 | 1.375 | 1.02 | 1.590 | .188 | .1380-32 UNJC-3B | NA2092S-62L |
| CE102S-27 | 27 | 1.34 | .968 | .66 | 1.078 | .165 | .1120-40 UNJC-3B | NA2092S-40L |
| CE102S-28 | 28 | 2.06 | 1.562 | 1.21 | 1.850 | .188 | .1380-32 UNJC-3B | NA2092S-62L |
| CE102S-32 | 32 | 2.56 | 1.750 | 1.39 | 2.090 | .210 | .1640-32 UNJC-3B | NA2092S-82L |
| CE102S-36 | 36 | 2.50 | 1.937 | 1.55 | 2.350 | .210 | .1640-32 UNJC-3B | NA2092S-82L |
| CE102S-37 | 37 | 1.56 | 1.187 | .88 | 1.266 | .165 | .1120-40 UNJC-3B | NA2092S-40L |
| CE102S-40 | 40 | 2.92 | 2.187 | 1.69 | 2.590 | .210 | .1640-32 UNJC-3B | NA2092S-82L |
| CE102S-44 | 44 | 3.18 | 2.375 | 1.88 | 2.850 | .210 | .1640-32 UNJC-3B | NA2092S-82L |
| CE102S-48 | 48 | 3.42 | 2.625 | 2.13 | 3.090 | .210 | .1640-32 UNJC-3B | NA2092S-82L |
| CE102S-61 | 61 | 1.88 | 1.437 | 1.12 | 1.578 | .210 | .1640-32 UNJC-3B | NA2092S-82L |
| CE102S-71 | 71 | 1.78 | 1.375 | 1.06 | 1.500 | .188 | .1380-32 UNJC-3B | NA2092S-62L |
| CE102S-72 | 72 | 1.53 | 1.031 | .60 | .915 | .188 | .1380-32 UNJC-3B | NA2092S-62L |

MATERIAL: PLATE-- 2024-T3 ALUMINUM PER AMS-QQ-A-250/4.
NUT -- TYPE 303 CRES PER ASTM A581 OR ASTM A582.

FINISH: PLATE-- ALODINE PER MIL-DTL-5541.
NUT-- PASSIVATED PER AMS2700 PLUS DRY FILM LUBRICANT PER ASS272.

SERVICE TEMP: TO 250°

VARIATIONS: FOR OTHER SIZES AND MATERIALS CONTACT NAFCO USA.

APPLICATION: FOR USE IN LIEU OF SELF-LOCKING HEX NUTS FOR MOUNTING ELECTRICAL RECEPTALS TO BULKHEADS OR FLANGES, ETC.

- NOTES:
1. THE JIFFYNUT IS A MECHANICALLY LOCKED-IN SELF-LOCKING NUT MEETING THE REQUIREMENTS OF NASM45938.
 2. CE102S-() NUT MAY BE USED UNTIL ALL INVENTORY IS DEPLETED.

EXAMPLE CALLOUT:

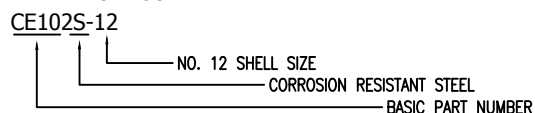

SHEET 1 OF 1

CONFORMS TO:
NASM45938
AS8879

NAFCO USA, LLC

CARSON CITY, NV 89706

PART NUMBER

CE102S

FSC / CAGE CODE: 32387