



NUT, SELF-LOCKING, SLAB

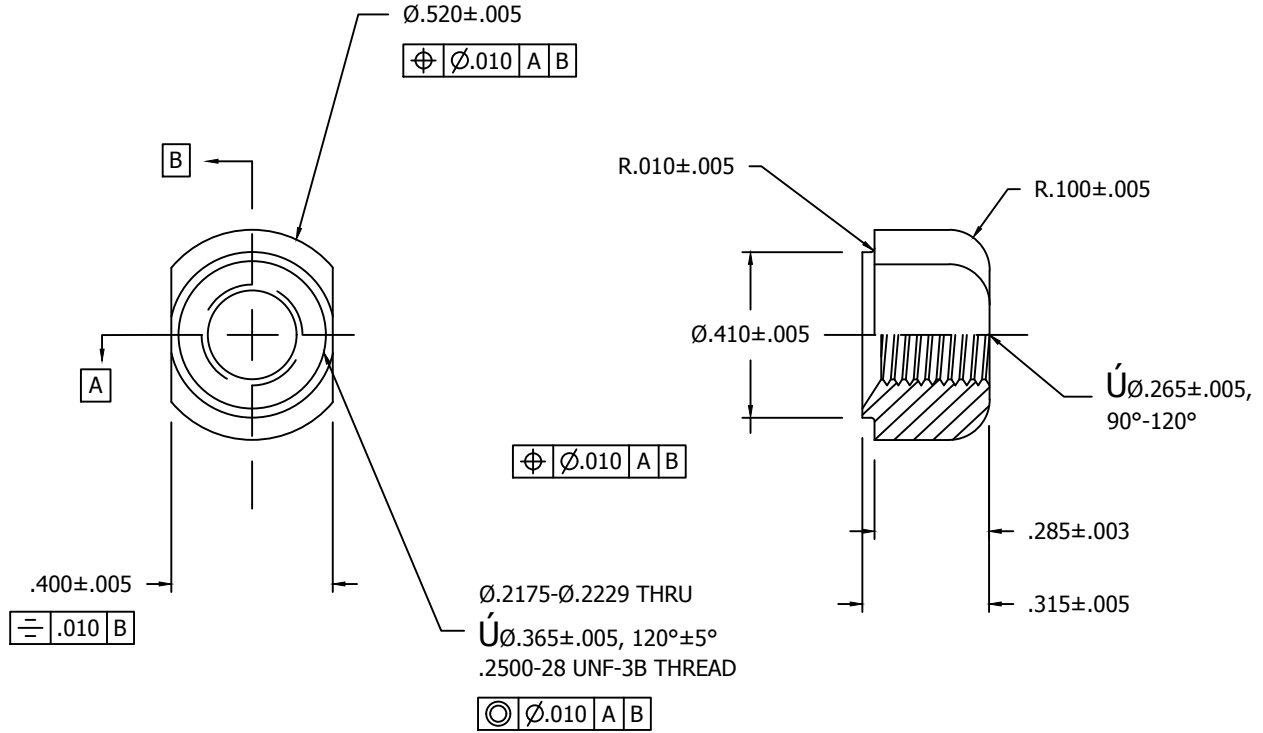

TABLE I - MATERIALS AND FINISH DATA

PART NUMBER	THREAD T (AS8879)	CODE	MATERIAL	SPECIFICATION	FINISH	SPECIFICATION
NA2232-048	.2500-28 UNF-3B	NO CODE	.5625" RND E4130 ALLOY STEEL	MIL-S-6758 AMS 6370	CAD PLATE	AMS-QQ-P-416 TY II, CLASS 2

MATERIAL: .5625" RND E4130 ALLOY STEEL.

FINISH: CADMIUM PLATED PER AMS-QQ-P-416, TYPE II, CLASS 2.
 DF - DRY FILM LUBE PER MIL-PRF-46010
 CW - CARBOWAX

- NOTES:**
- (1) REMOVE ALL BURRS AND SHARP EDGES; BREAK SHARP EDGES .005 MAX.
 - (2) .005 T.I.R. ALL SURFACES.
 - (3) DEFORMATION FROM SELF-LOCKING FEATURE PERMISSIBLE ON BARREL END.
 - (4) IDENTIFY PER MIL-STD-130.5Y CONTAINER.
 - (5) THREADS PER AS8879 BEFORE LUBRICATION.
 - (6) CADMIUM PLATE PER AMS-QQ-P-416 PLUS AN APPROVED LUBRICANT. TYPE AND CLASS OF PLATING IS OPTIONAL. IF LUBRICATED NUT WILL MEET THE SALT SPRAY REQUIREMENTS OF AMS-QQ-P-416, TYPE II.
 - (7) NUT SHALL CONFORM TO NAS3350, CLASS III.

CONFORMS TO:
 NASM25027
 AS8879

NAFCO USA, LLC
 CARSON CITY, NV 89706

PART NUMBER
NA2232
 FEDERAL SUPPLY CODE: 32387