



JIFFYNUT, MINIATURE, SELF-LOCKING AND NON-LOCKING

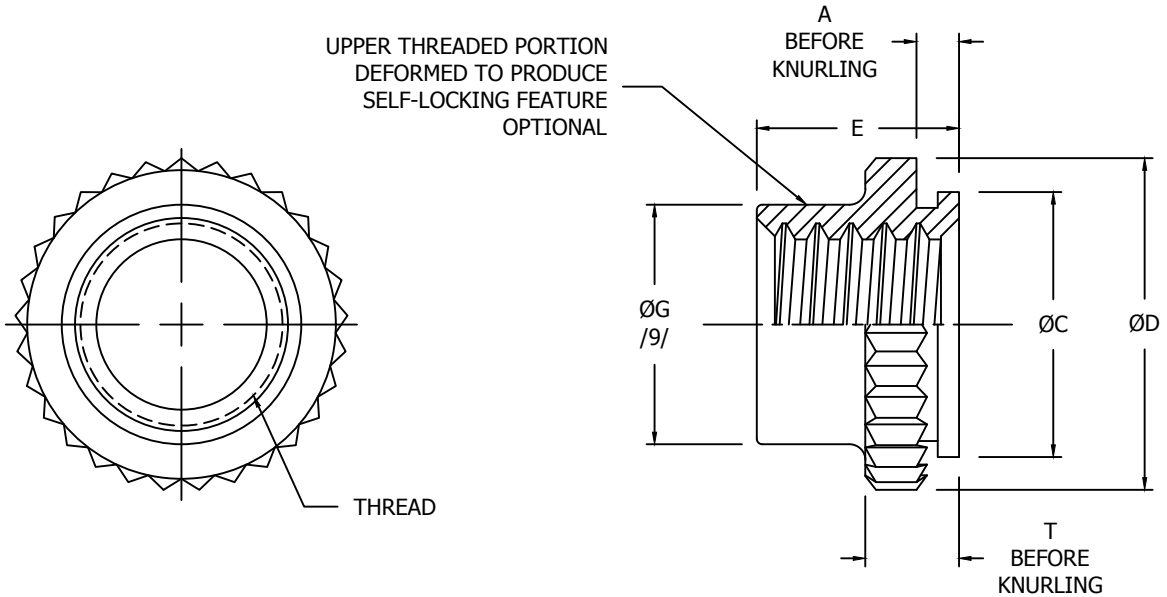

TABLE I - PART DIMENSIONS AND DASH NUMBERS

DASH NUMBER		THREAD (AS8879)	A ±.004	SHEET THKNS MIN	HOLE SIZE IN SHEET +.004 -.001	ØC +.001 -.004	ØD ±.015	E ±.015	ØG ±.005	T ±.005	CENTER OF HOLE TO SHEET EDGE MIN /5/
ALLOY STEEL (450°F)	CRES A286 (600°F)										
-26	-26C	.0860-56 UNJC-3B	.030	.040	.125	.123	.190	.140	.106	.078	.188
-40	-40C	.1120-40 UNJC-3B	.030	.040	.156	.154	.220	.160	.135	.078	.203
-62	-62C	.1380-32 UNJC-3B	.030	.040	.188	.186	.250	.178	.161	.078	.250
-82	-82C	.1640-32 UNJC-3B	.040	.050	.219	.217	.280	.188	.200	.088	.281
-02	-02C	.1900-32 UNJF-3B	.040	.050	.281	.279	.350	.188	.240	.088	.281

TABLE II - PUSH-OUT AND TORQUE-OUT VALUES

SIZE	APPROX. INSTALL FORCE LBF	PUSH-OUT LBF MIN.	TORQUE-OUT LBF-IN MIN.
.0860	2,200	80	10
.1120	2,400	120	20
.1380	2,600	160	30
.1640	3,400	240	45
.1900	4,000	360	60

CONFORMS TO:
NASM25027
AS8879

NAFCO USA, LLC
CARSON CITY, NV 89706

PART NUMBER
NA2158
FEDERAL SUPPLY CODE: 32387