

NUT, PLATE, SELF-LOCKING, LOW HEIGHT, FIXED, TWO LUG

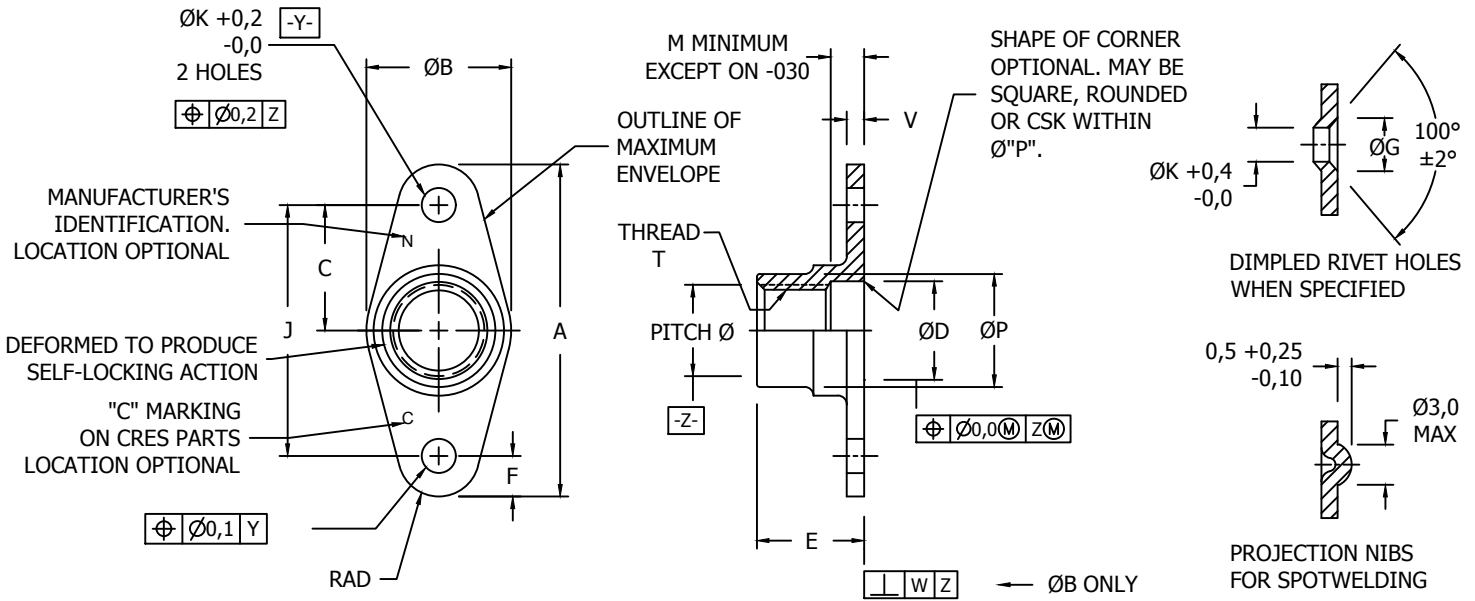

TABLE I - DIMENSIONS AND DASH NUMBERS

NAFCO PART NUMBER				T THREAD /2/	A MAX	ØB MAX	C	ØD MIN
STEEL		CRES						
CADMIUM +MoS ₂ 235°C	CADMIUM W/O MoS ₂ 235°C	SILVER PLATE 425°C	MoS ₂ W/O SILVER 235°C					
NA2452A-3M	NA2452X-3M	NA2452CS-3M	NA2452CM-3M	MJ3 x 0,5 - 4H6H	17,2	6,0	6,0	---
NA2452A-4M	NA2452X-4M	NA2452CS-4M	NA2452CM-4M	MJ4 x 0,7 - 4H6H	23,2	8,0	8,5	4,4
NA2452A-5M	NA2452X-5M	NA2452CS-5M	NA2452CM-5M	MJ5 x 0,8 - 4H6H	25,2	9,0	9,5	5,5
NA2452A-6M	NA2452X-6M	NA2452CS-6M	NA2452CM-6M	MJ6 x 1 - 4H5H	29,2	10,0	11,0	6,5
NA2452A-8M	NA2452X-8M	NA2452CS-8M	NA2452CM-8M	MJ8 x 1 - 4H5H	29,2	13,0	11,0	8,5
NA2452A-10M	NA2452X-10M	NA2452CS-10M	NA2452CM-10M	MJ10 x 1,25 - 4H5H	35,2	16,2	13,0	10,5

T THREAD /2/	E MAX /1/	F MIN	ØG ±0,25	J	ØK	M MIN	ØP MAX	V MAX	W MAX	MASS kg/100		AXIAL TENSILE FORCE kN
										(AVG)	MAX	
MJ3 x 0,5 - 4H6H	3,2	2,5	5,0	12,0	2,5	---	3,6	0,7	0,13	0,17	0,19	6,18
MJ4 x 0,7 - 4H6H	5,8	3,0	5,0	17,0	2,5	2,2	6,3	1,0	0,15	0,19	0,21	10,9
MJ5 x 0,8 - 4H6H	6,9	3,0	5,0	19,0	2,5	2,4	7,3	1,0	0,15	0,22	0,24	17,3
MJ6 x 1 - 4H5H	8,1	3,5	5,0	22,0	2,5	2,7	8,7	1,3	0,15	0,37	0,41	24,7
MJ8 x 1 - 4H5H	9,9	3,5	7,0	22,0	3,0	2,7	10,9	1,7	0,18	0,71	0,78	46,7
MJ10 x 1,25 - 4H5H	12,0	4,5	7,0	26,0	3,5	3,0	12,9	1,7	0,20	0,99	1,10	72,9

MATERIAL: STEEL -- CARBON OR ALLOY STEEL, HEAT TREATED.
CRES (UNS S66286) -- A286 PER AMS5525, AMS5732, OR AMS5737.

FINISH: STEEL -- CADMIUM PLATE PER AMS-QQ-P-416, TYPE II, CLASS 2.
CRES -- FOR 425°C USE SILVER PLATE PER AMS2410 TO A 5µm MINIMUM THICKNESS ON SURFACES WHICH CAN BE TOUCHED BY A 20 mm DIAMETER BALL. THREADS SHALL SHOW COMPLETE COVERAGE, BUT THICKNESS REQUIREMENT ON THREADS IS WAIVED.

LUBRICANT: MOLYBDENUM DISULFIDE DRY FILM LUBRICANT IN ACCORDANCE WITH AS5272.

CONFORMS TO:
NASM25027
AS8879

NAFCO USA, LLC
CARSON CITY, NV 89706

PART NUMBER
NA2452
FSCM / CAGE CODE: 32387