



NUT, HEX, SELF-LOCKING, CAPPED, 125,000 PSI

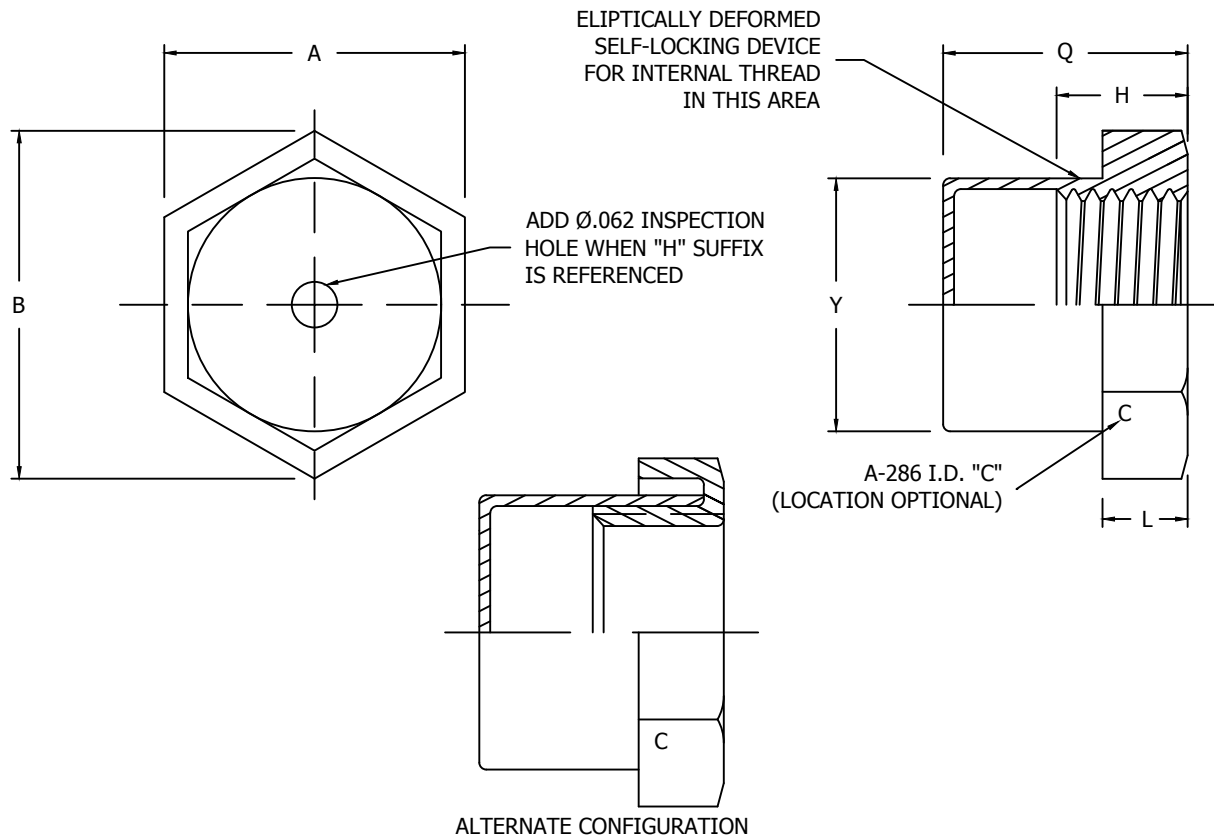

TABLE I - DIMENSIONS AND DASH NUMBERS

NAFCO PART NUMBER		THREAD AS8879	A	B REF.	H TH'D LENGTH MAX.	L MIN.	Q ±.010	Y MAX.	APPROX. WT. LBS./100
STEEL 450°F	CRES 900°F								
NA2139-40K	NA2139C-40K	.1120-40 UNJC-3B	.240-	.289	.120	.081	.296	.198	.17
NA2139-40K1	NA2139C-40K1		.252				.182		.22
NA2139-62K	NA2139C-62K	.1380-62 UNJC-3B	.302-	.361	.136	.092	.468	.228	.30
NA2139-62K1	NA2139C-62K1		.314				.328		.26
NA2139-82K	NA2139C-82K	.1640-32 UNJC-3B	.334-	.390	.188	.122	.468	.252	.40
NA2139-82K1	NA2139C-82K1		.346				.328		.35
NA2139-02K	NA2139C-02K	.1900-32 UNJF-3B	.367-	.430	.188	.122	.468	.280	.45
NA2139-02K1	NA2139C-02K1		.376				.328		.40
NA2139-048K	NA2139C-048K	.2500-28 UNJF-3B	.430-	.506	.219	.142	.484	.347	.67
NA2139-048K1	NA2139C-048K1		.439				.375		.62
NA2139-054K	NA2139C-054K	.3120-24 UNJF-3B	.492-	.580	.266	.173	.547	.416	.95
NA2139-054K1	NA2139C-054K1		.502				.437		.89
NA2139-064K	NA2139C-064K	.3750-24 UNJF-3B	.553-	.650	.282	.183	.547	.505	1.25
NA2139-064K1	NA2139C-064K1		.564				.437		1.16
NA2139-070K	NA2139C-070K	.4375-20 UNJF-3B	.679-	.790	.328	.213	.612	.625	1.65
NA2139-070K1	NA2139C-070K1		.690				.500		1.51
NA2139-080K	NA2139C-080K	.5000-20 UNJF-3B	.741-	.870	.328	.213	.612	.687	2.18
NA2139-080K1	NA2139C-080K1		.752				.500		1.99

CONFORMS TO:
NASM25027
AS8879

NAFCO USA, LLC
CARSON CITY, NV 89706

PART NUMBER
NA2139
FSC/CAGE CODE: 32387