

# CLINCHNUT SELF-LOCKING

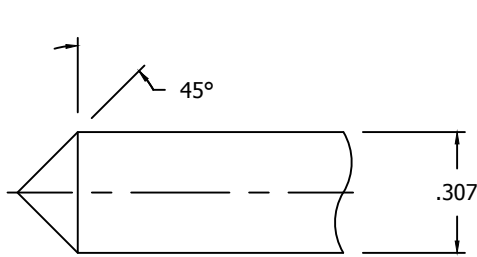

FOR THREAD SIZES .0860, .1120 AND .1380

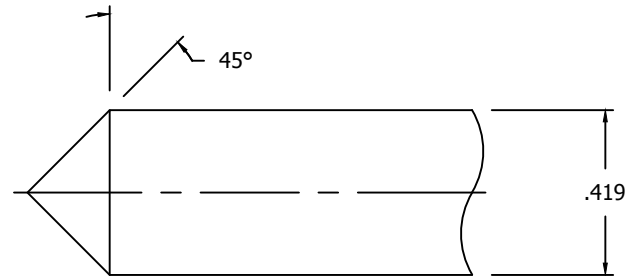

FOR THREAD SIZES .1640 AND .1900

FIGURE 4 - FLUSH FLARING TOOL  
USE WHEN SHEET THICKNESS IS EQUAL TO OR LESS THAN SHANK LENGTH "A".  
SEE TABLE I.

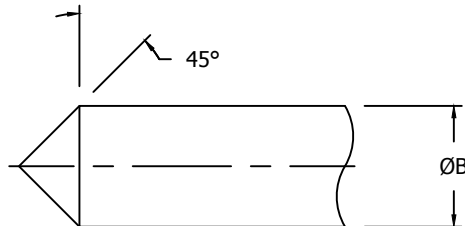

NUT SIZE	ØB +.000 -.002
.0860	.120
.1120	.151
.1380	.183
.1640	.214
.1900	.245

FIGURE 5 - INTERNAL FLARING TOOL  
USE WHEN SHEET THICKNESS IS GREATER THAN SHANK LENGTH "A".  
SEE TABLE I.

CONFORMS TO:  
NASM25027  
AS8879  
NASM45938

## NAFCO USA, LLC

CARSON CITY, NV 89706

PART NUMBER

### NA2311

FEDERAL SUPPLY CODE: 32387