

MOLDSERT, NON-LOCKING AND MID-GRIP SELF-LOCKING

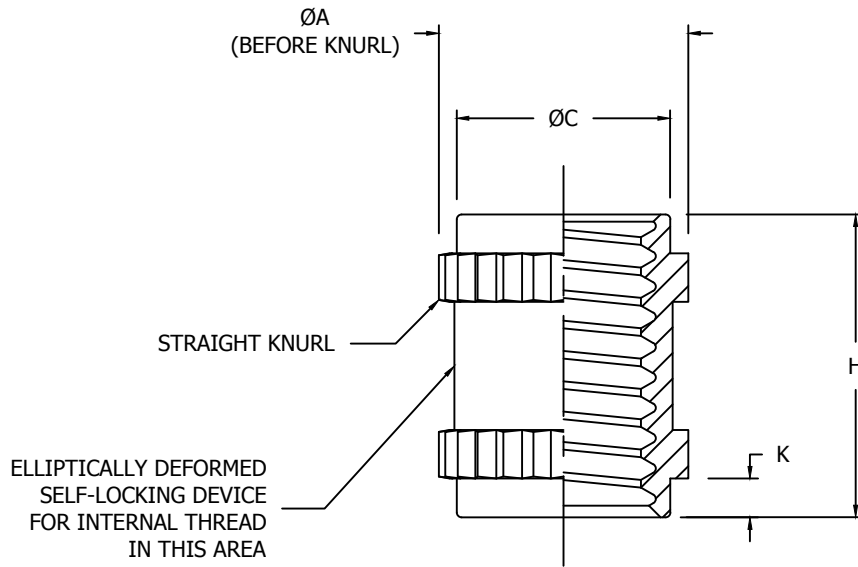

TABLE I - DIMENSIONS AND DASH NUMBERS

NAFCO PART NUMBER	THREAD (AS8879)	$\varnothing A$ REF	$\varnothing C$ $\pm .010$	H $\pm .002$	K REF	APPROX. WEIGHT LBS./100
CE144-00	.0600-80 UNJF-3B	.125	.115	.206	.025	.03
CE144-26	.0860-56 UNJC-3B	.140	.130	.219	.025	.04
CE144-40	.1120-40 UNJC-3B	.190	.180	.253	.031	.09
CE144-62	.1380-32 UNJC-3B	.190	.180	.253	.031	.09
CE144-82	.1640-32 UNJC-3B	.220	.200	.312	.040	.13
CE144-02	.1900-32 UNJF-3B	.250	.220	.312	.040	.14
CE144-048	.2500-28 UNJF-3B	.312	.275	.312	.040	.25
CE144-054	.3120-24 UNJF-3B	.438	.375	.375	.050	.45
CE144-064	.3750-24 UNJF-3B	.500	.430	.410	.050	.85

MATERIAL: 303 CRES PER AMS5640 OR AMS5641.

FINISH: PASSIVATED PER AMS2700.

LUBRICANT: SOLID FILM LUBRICANT PER AS5272 IF SELF-LOCKING TYPE.

SERVICE TEMP.: TO 450°F IF SELF-LOCKING TYPE, TO 800°F IF NON-LOCKING TYPE.

CONFORMS TO:
NASM25027
AS8879

NAFCO USA, LLC
CARSON CITY, NV 89706

PART NUMBER
CE144

FSC / CAGE CODE: 32387