



MOLDSERT, PLUGGED NON-LOCKING AND MID-GRIP SELF-LOCKING

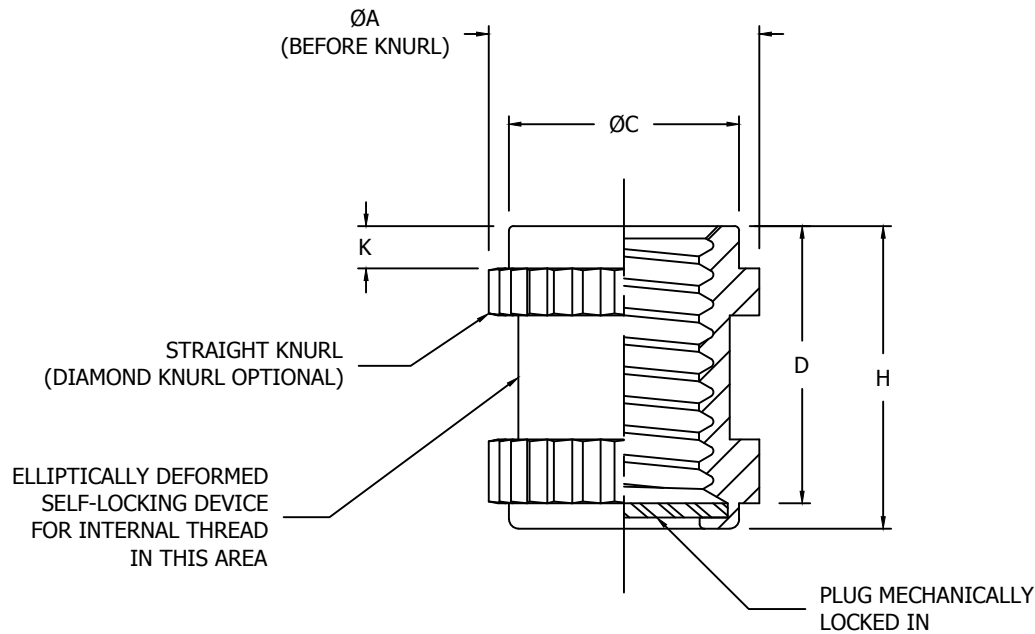

TABLE I - DIMENSIONS AND DASH NUMBERS

NAFCO PART NUMBER	THREAD (AS8879)	A REF	C ±.010	D MIN. FULL THREAD	H REF	K REF	APPROX. WEIGHT LBS./100
CE150S-26	.0860-56 UNJC-3B	.156	.13	.13	.20	---	.05
CE150S-40	.1120-40 UNJC-3B	.188	.16	.15	.22	.025	.10
CE150S-62	.1380-32 UNJC-3B	.219	.17	.19	.26	.040	.11
CE150S-82	.1640-32 UNJC-3B	.250	.22	.25	.32	.040	.14
CE150S-02	.1900-32 UNJF-3B	.281	.24	.28	.35	.045	.16
CE150S-048	.2500-28 UNJF-3B	.344	.30	.35	.44	.050	.28
CE150S-054	.3125-24 UNJF-3B	.438	.37	.41	.50	.050	.50
CE150S-064	.3750-24 UNJF-3B	.500	.43	.49	.58	.050	1.00

MATERIAL: 303 CRES PER AMS5640 OR AMS5641.

FINISH: PASSIVATED PER AMS2700.

LUBRICANT: SOLID FILM LUBRICANT PER AS5272 IF SELF-LOCKING TYPE.

SERVICE TEMP.: LOCKING: TO 450°F.
NON-LOCKING: TO 800°F.

CONFORMS TO:
NASM25027
AS8879

NAFCO USA, LLC
CARSON CITY, NV 89706

PART NUMBER
CE150S
FSC / CAGE CODE: 32387