



MOLDSERT, MID-GRIP, SELF-LOCKING

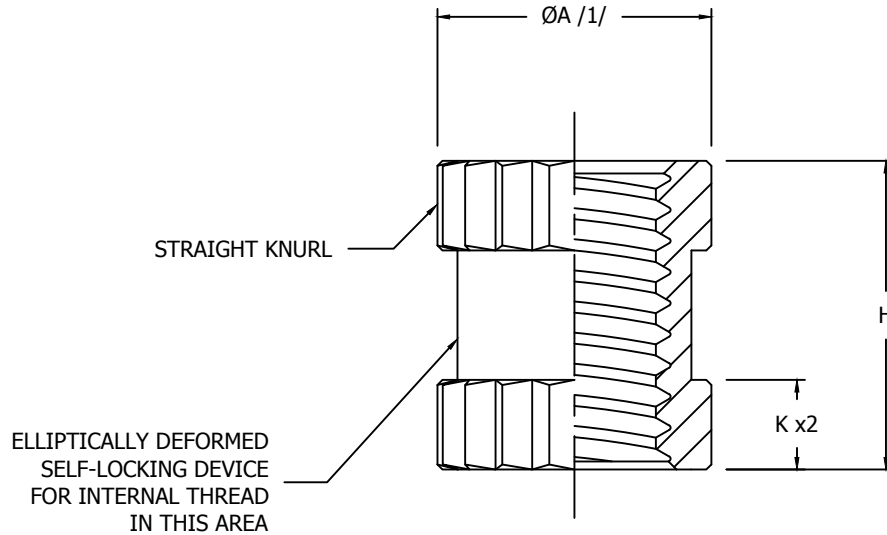

TABLE I - DIMENSIONS AND DASH NUMBERS

NAFCO PART NUMBER	THREAD (AS8879)	ØA REF. /1/	H ±.002	K REF.
NA2274-02	.1900-32 UNJF-3B	.275	.310	.090

MATERIAL: E4130 AQ STEEL PER AMS6348, AMS6370, OR AMS6382.

FINISH: CAD PLATE PER AMS-QQ-P-416, TYPE II, CLASS 3.

APPLICATION: FOR MOLDING IN PLASTICS AND ALUMINUM. PROVIDES ADDITIONAL TENSILE STRENGTH, INCREASED RESISTANCE TO THREAD WEAR, AND LOCKING OF SCREW INTO THREADED JOINT.

VARIATIONS: OTHER MATERIALS AND SIZES AVAILABLE UPON SPECIAL REQUEST.

CODES: "L" CODE -- SUFFIXED TO DASH NUMBER INDICATED SELF-LOCKING FEATURE.

CONFORMS TO:
NASM25027
AS8879

NAFCO USA, LLC
CARSON CITY, NV 89706

PART NUMBER
NA2274
FSC / CAGE CODE: 32387