



MOLDSERT, MID-GRIP SELF-LOCKING, ENCAPSULATING SLEEVE

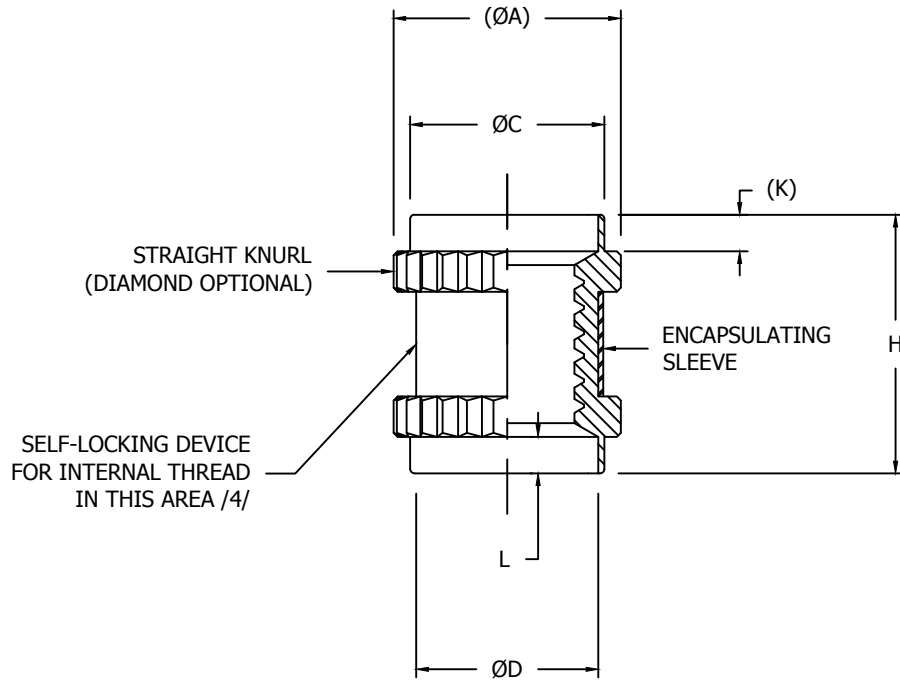

TABLE I - DIMENSIONS AND DASH NUMBERS

NAFCO DASH NUMBER		THREAD	$(\varnothing A)$ /3/	$\varnothing C$ $\pm .010$	$\varnothing D$ MIN	L $\pm .005$	H $\pm .005$	(K)	APPROX. WEIGHT LBS./100
303 CRES	A-286 CRES	(AS8879)							
NA2047S-26	NA2047C-26	.0860-56 UNJC-3B	.156	.130	---	---	.190	.025	.05
NA2047S-40	NA2047C-40	.1120-40 UNJC-3B	.188	.160	.112	.025	.210	.025	.10
NA2047S-62	NA2047C-62	.1380-32 UNJC-3B	.219	.170	.138	.040	.253	.040	.11
NA2047S-82	NA2047C-82	.1640-32 UNJC-3B	.250	.220	.164	.040	.312	.040	.14
NA2047S-02	NA2047C-02	.1900-32 UNJF-3B	.281	.240	.190	.045	.340	.045	.16
NA2047S-048	NA2047C-048	.2500-28 UNJF-3B	.344	.300	.250	.050	.430	.050	.28
NA2047S-054	NA2047C-054	.3125-24 UNJF-3B	.438	.370	.313	.050	.490	.050	.50
NA2047S-064	NA2047C-064	.3750-24 UNJF-3B	.500	.430	.375	.050	.570	.050	1.00

MATERIAL: NUT -- TYPE 303 PER AMS5640 OR AMS5641.
TYPE A-286 PER AMS5731, AMS5732, AMS5734 OR AMS5737.

ENCAPSULATING SLEEVE -- IRRADIATED POLYOLEFIN.

FINISH: PASSIVATE PER AMS2700.

LUBRICATION: NAFCO CARBOWAX LUBRICANT.

CONFORMS TO:
NASM25027
AS8879

NAFCO USA, LLC
CARSON CITY, NV 89706

PART NUMBER
NA2047
FSC / CAGE CODE: 32387